



Vernon Drive Stanmore Offers over £850,000

A five bedroom semi detached house available with Davidson Frost-Wellings.

Downstairs the house has a double reception room, galley kitchen and a bright dining room with sliding doors leading to the private rear garden. In addition there is a downstairs bedroom with ensuite shower room and a separate study. Upstairs, on the first floor, the property has a large bedroom with ensuite bathroom, two double bedrooms, a family bathroom and a single bedroom.

The large rear garden extends to nearly 90' with large outbuildings offering an additional 200 sq ft of space.

Vernon Drive, Stanmore, is a popular road within the catchment area of two Outstanding Ofsted-rated schools: St Joseph's and Belmont School, and offers easy access to Belmont United Synagogue.

Harrow council tax band E.

Viewing

Please contact our Davidson Frost-Wellings Office on 020 8954 8806 if you wish to arrange a viewing appointment for this property or require further information.

- Five bedrooms
- Three bathrooms
- Large rear garden
- Outbuildings
- Great location
- Semi detached



5



3



3



C

Floor Plan

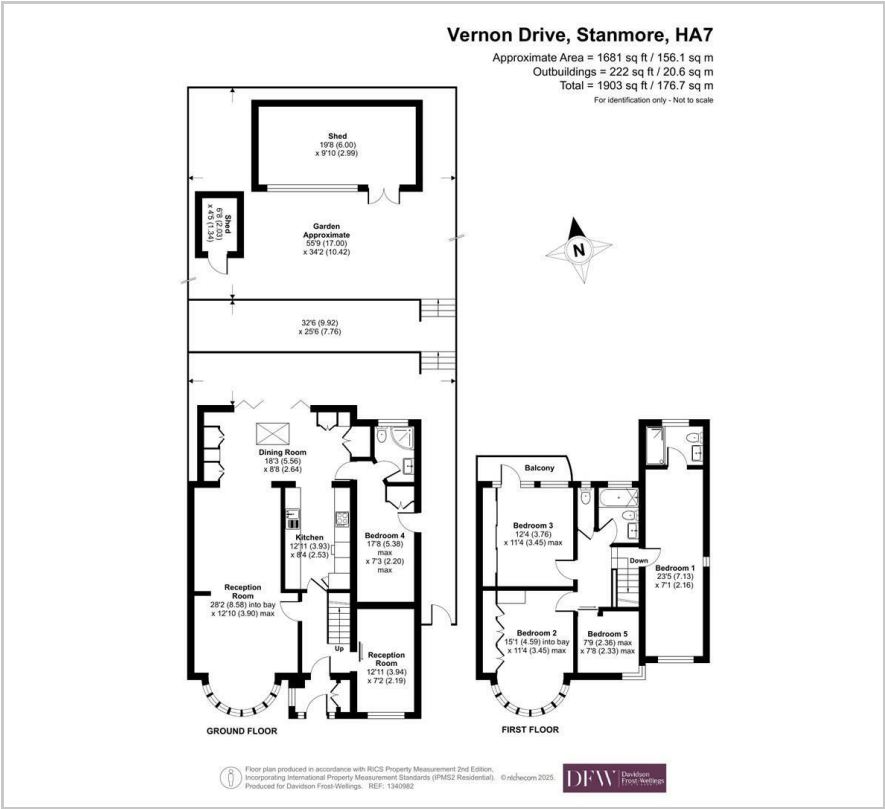

Area Map

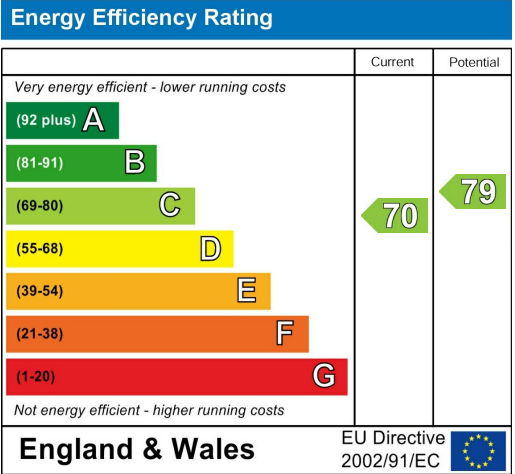

These particulars, whilst believed to be accurate are set out as a general outline only for guidance and do not constitute any part of an offer or contract. Intending purchasers should not rely on them as statements of representation of fact, but must satisfy themselves by inspection or otherwise as to their accuracy. No person in this firms employment has the authority to make or give any representation or warranty in respect of the property.